

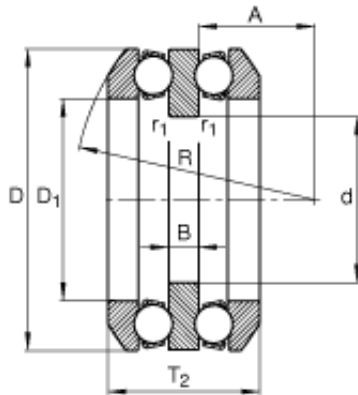

MACHINE DE MEXICO, S.A. DE C.V.



30 mm x 68 mm x 9 mm FAG 54208 Thrust Ball Bearing

Bearing No. 54208

Size	30x68x38.6 mm
Bore Diameter	30 mm
Outer Diameter	68 mm
Width	38,6 mm
d	30 mm
D	68 mm
T ₂	38,6 mm
A	25 mm
B	9 mm
D ₁	42 mm
D _{a max}	55 mm
d _{a max}	40 mm
R	56 mm
r _{1 min}	0,6 mm
r _{a max}	1 mm
r _{a1 max}	0,6 mm
r _{min}	1 mm
m	0,513 kg / Weight
C _a	46500 N / Dynamic load rating (axial)
C _{0a}	98000 N / Static load rating (axial)
A	0,05 / Factor min. load
n _G	5500 1/min / Limiting speed
C _{ua}	4300 N / Fatigue limit load,

54208 Bearing 2D drawings and 3D CAD models



MACHINE DE MEXICO,S.A.DE C.V.

	axial
--	-------